

**NOTE:**

1. MACHINE BLOCK BORE DOWN TO  $\phi 5.900 \pm .010$  AT  $\phi 3.950 \pm .005$  FOR HONE CLEARANCE
2. MACHINE BLOCK AT BORE CENTER OF 108mm / 4.252
3. MACHINE BLOCK BORES A, C, & D TO BE .001 TO .0015 CLEARANCE OF SLEEVE DIAMETERS
4. AT TIME OF INSTALLATION APPLY A SMALL AMOUNT OF LOCTITE #515 OR #518 TO THE INSIDE OF BLOCK BORE A
5. INSTALL SLEEVES AT ROOM TEMPERATURE AND CLAMP SLEEVES DOWN TO DECK UNTILL LOCTITE HAS FULLY CURED, THEN DECK SURFACE AND HONE

REVISIONS

REV	DESCRIPTION	DATE	APPROVAL

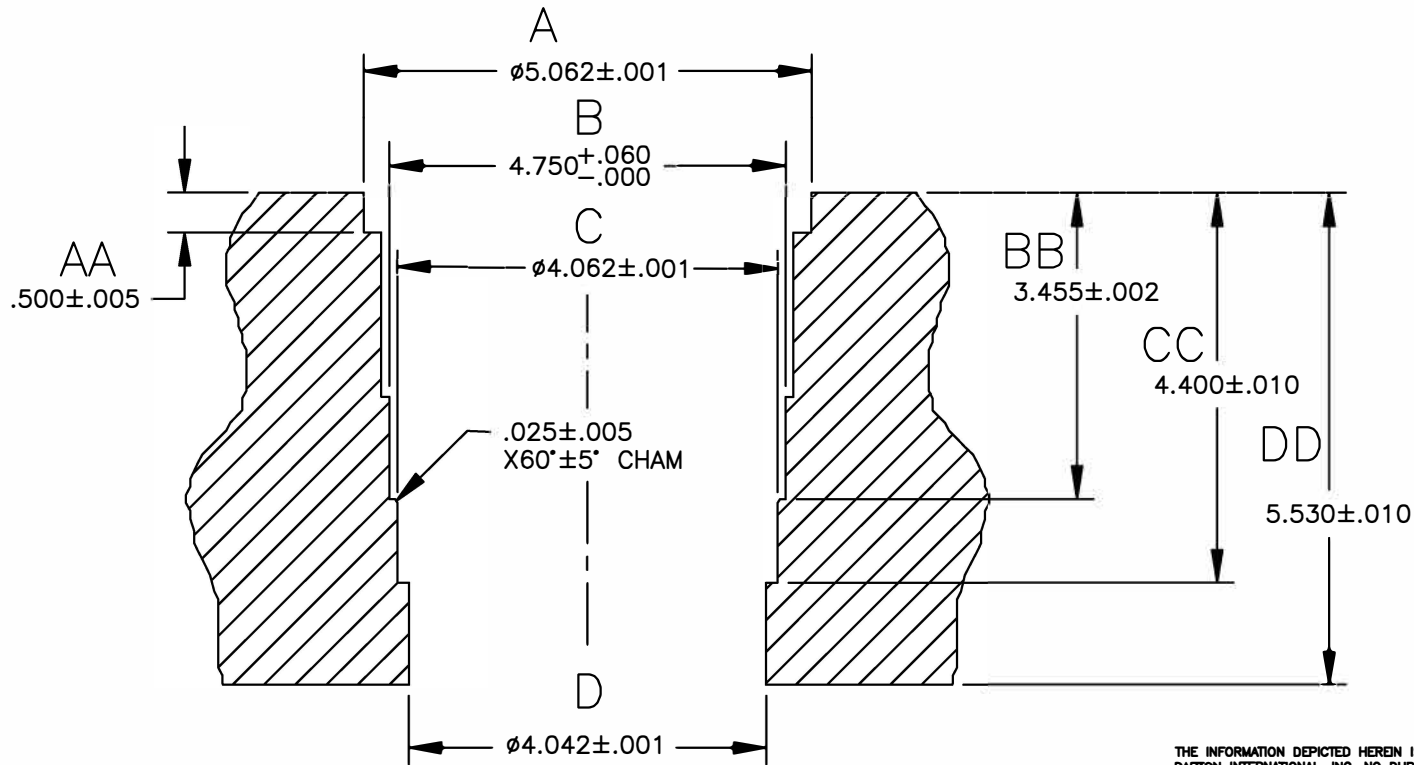

THE INFORMATION DEPICTED HEREIN IS PROPRIETARY DESIGN INFORMATION WHICH IS COPYRIGHTED DARTON INTERNATIONAL, INC. NO DUPLICATION OR USE OF THIS INFORMATION IS PERMITTED WITHOUT EXPRESS WRITTEN CONSENT OF DARTON INTERNATIONAL, INC.

DR. WR.	CAD DEPT		Darton International, Inc.	
DATE:	04/08/2010		Carlsbad, CA USA	
CHK'D BY:		(800) 713-2786 (760) 603-9895		
MATERIAL:		FAX (760) 603-9829		
HARDNESS:		WWW.DARTON-INTERNATIONAL.COM		
TITLE		BLOCK SPECIFICATION-		
SIZE		NISSAN VR-38 95.5-100mm		
SCALE		DWG NO.	800-215-D	REV
1/2				-
SHEET			1 OF 1	